

MISSISSIPPI

- PARISH SEATS
- MUNICIPALITIES
- COMMUNITIES
- PROJECTS LET BETWEEN JULY 2015 AND SEPTEMBER 2020
- PROJECTS TO BE LET BETWEEN OCTOBER 2020 AND JUNE 2021
- PROJECTS SCHEDULED TO BE LET IN SFY 21-22 (Next Fiscal Year)
- OTHER PROJECTS BEING DEVELOPED
- CONTROL SECTIONS / STATE ROUTES
- FERRY BOATS
- PARISH LINES
- URBANIZED AREAS
- URBAN AREAS

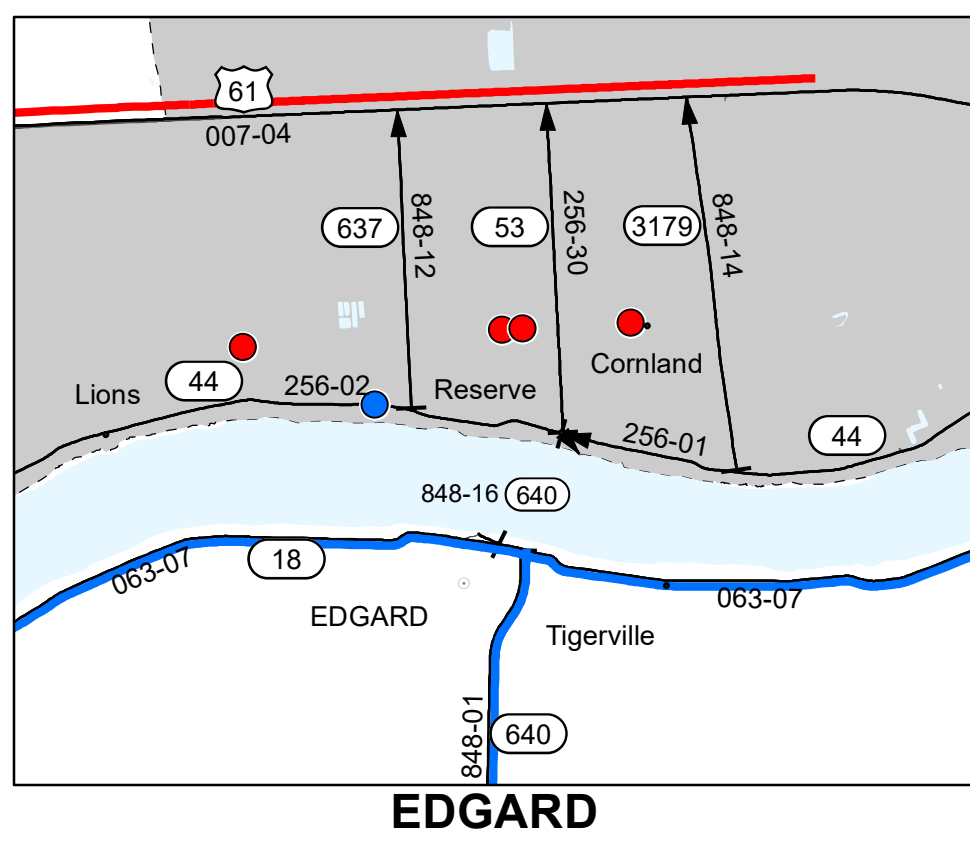
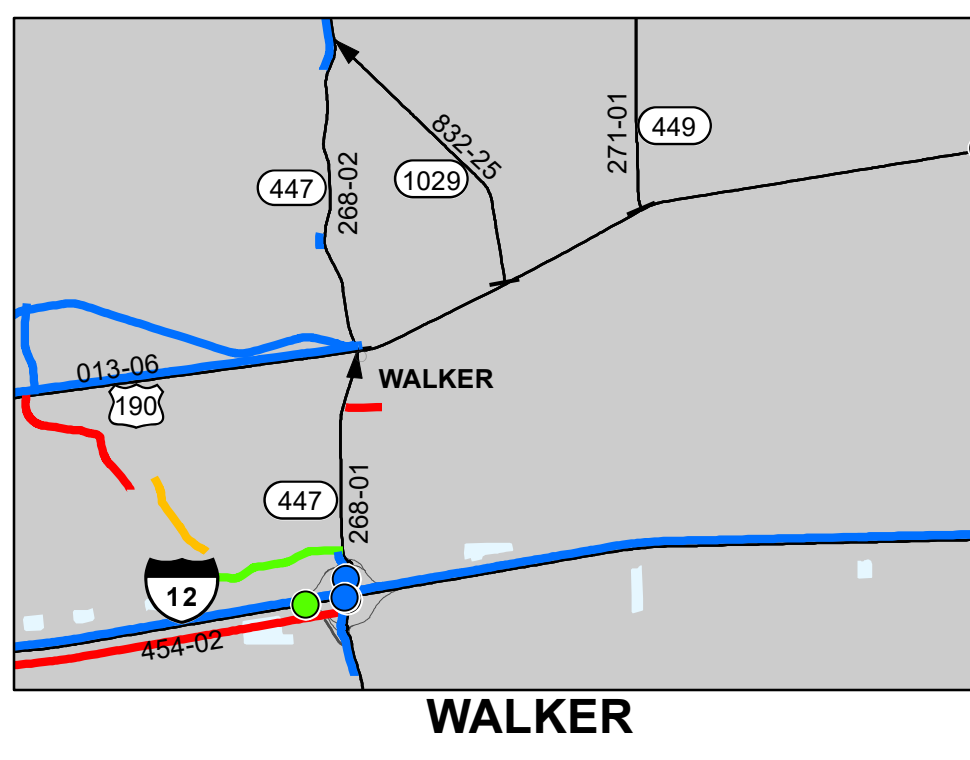
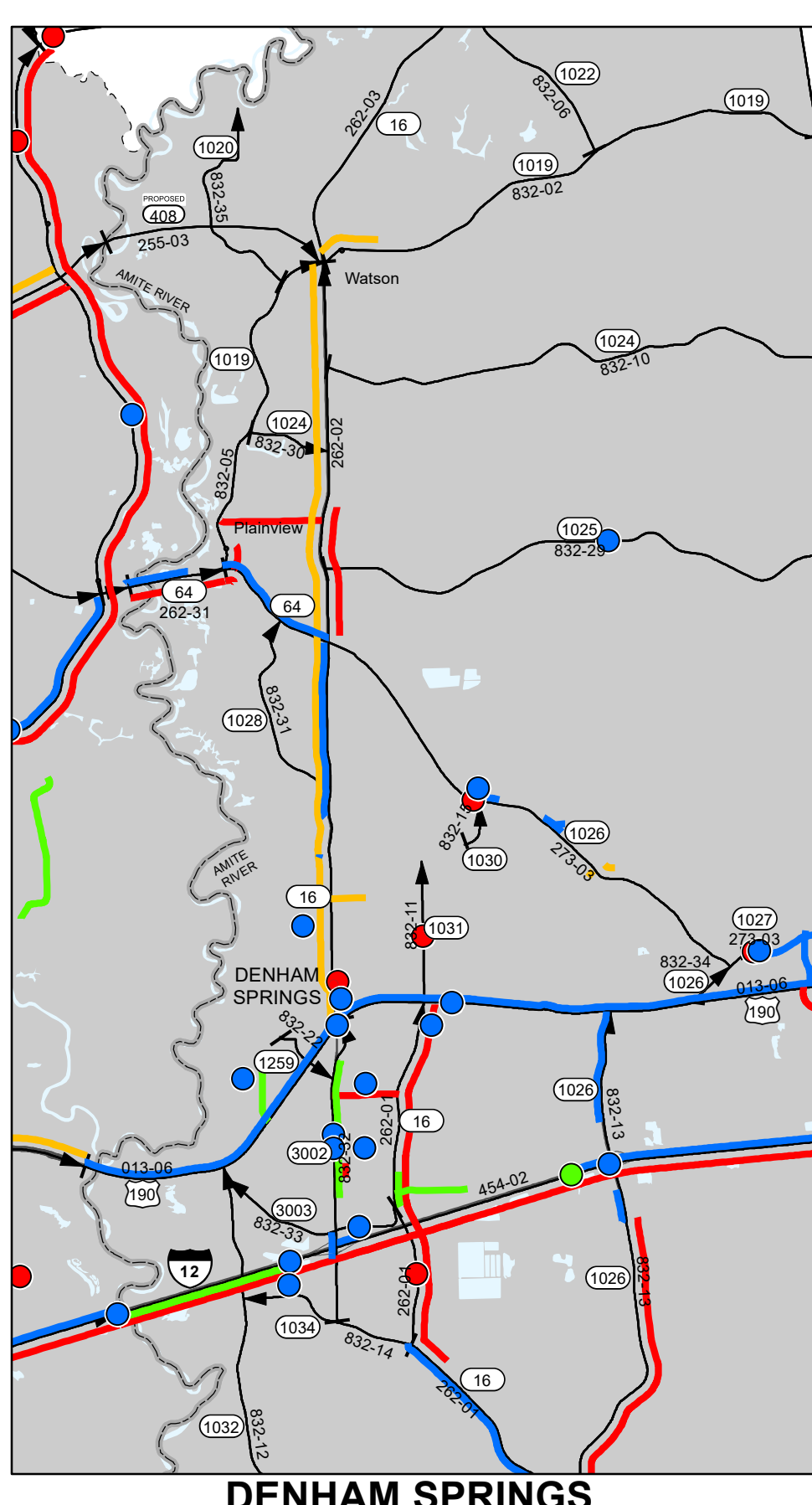
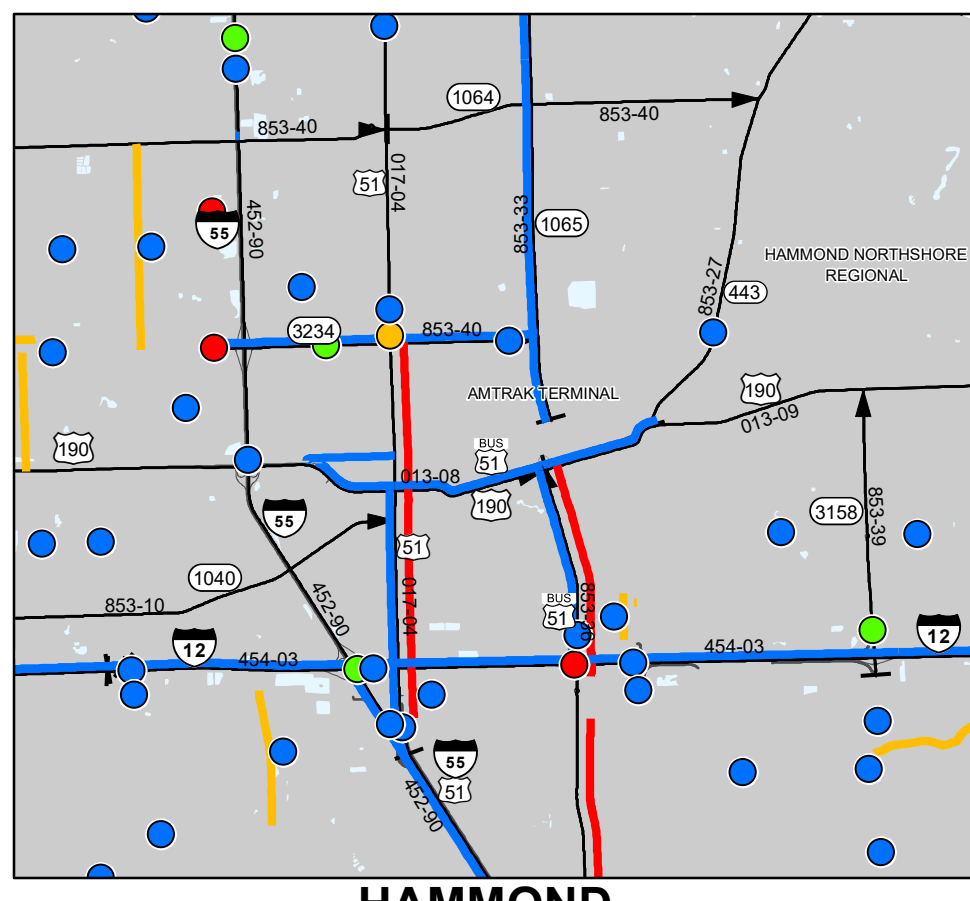
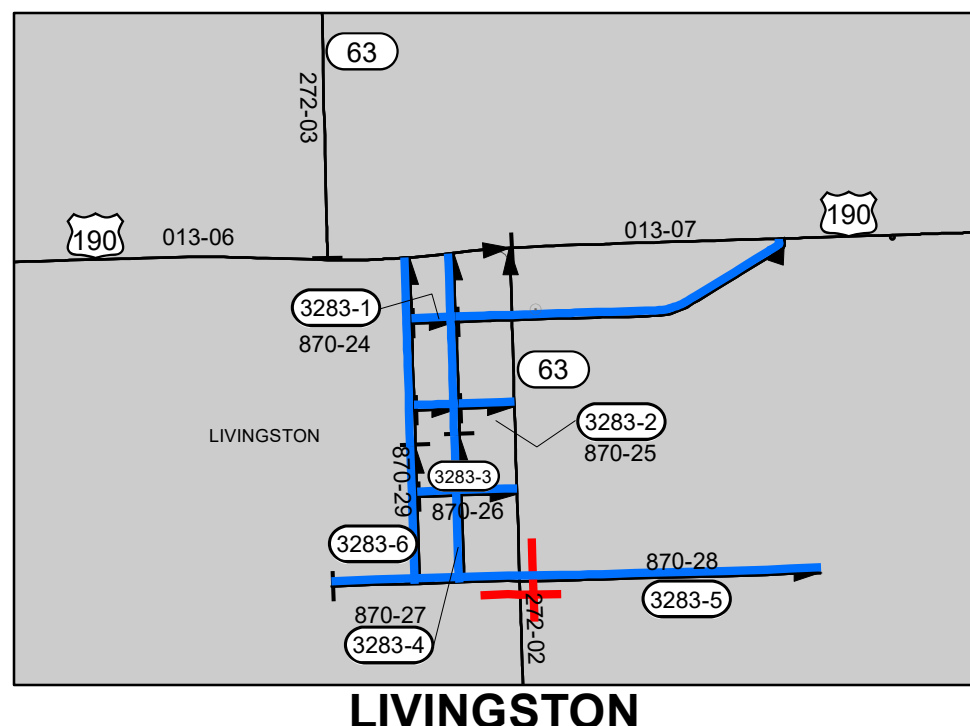
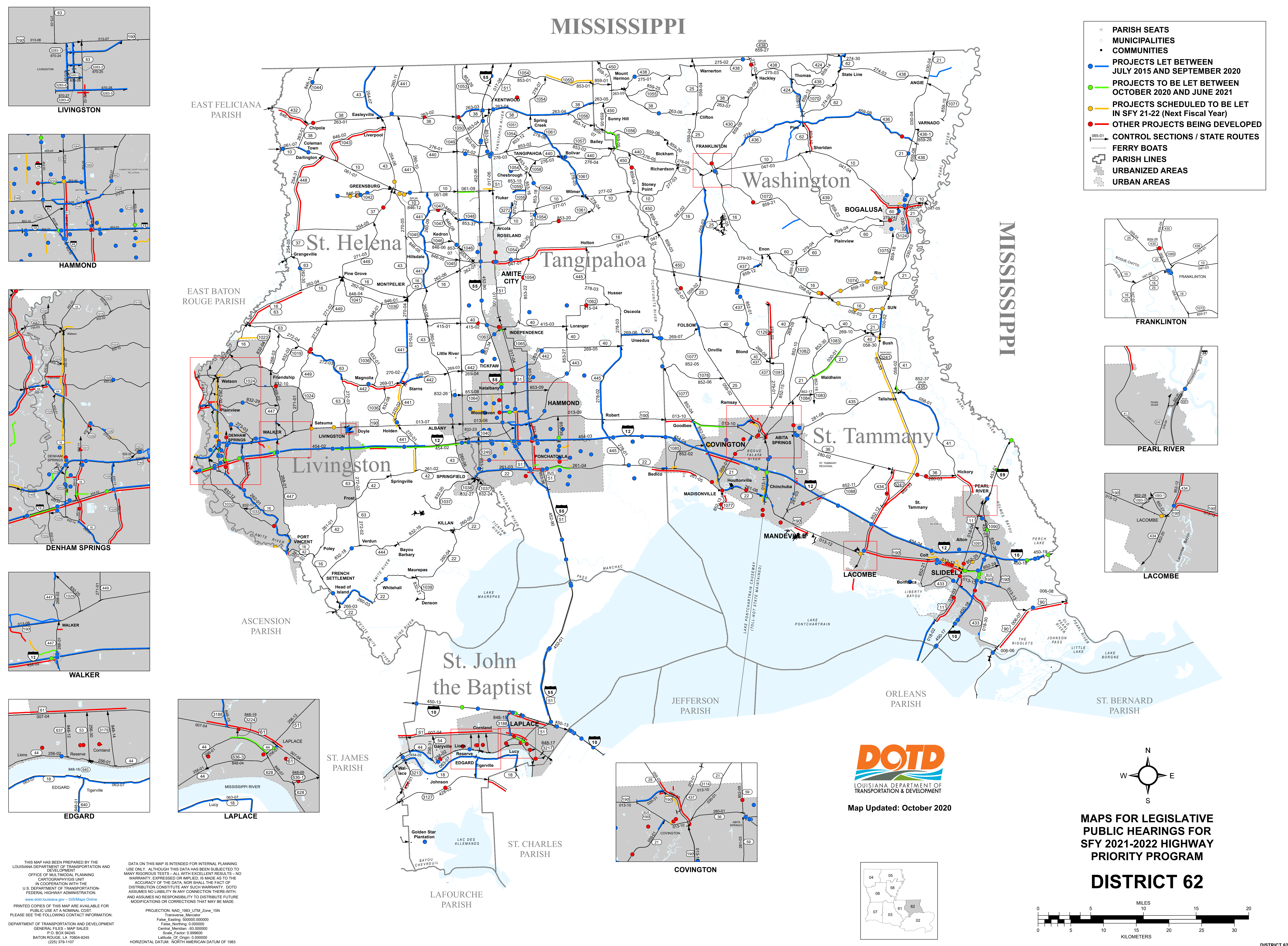

EAST FELICIANA PARISH

EAST BATON ROUGE PARISH

ASCENSION PARISH

ST. JAMES PARISH

LAPLACE

St. Helena

Livingston

St. John the Baptist

ST. CHARLES PARISH

LAFOURCHE PARISH

Tangipahoa

AMITE CITY

HAMMOND

St. John the Baptist

ST. CHARLES PARISH

LAFOURCHE PARISH

Washington

Tangipahoa

AMITE CITY

HAMMOND

St. John the Baptist

ST. CHARLES PARISH

LAFOURCHE PARISH

FRANKLINTON

Tangipahoa

AMITE CITY

HAMMOND

St. John the Baptist

ST. CHARLES PARISH

LAFOURCHE PARISH

BOGALUSA

Tangipahoa

AMITE CITY

HAMMOND

St. John the Baptist

ST. CHARLES PARISH

LAFOURCHE PARISH

St. Tammany

COVINGTON

MANDEVILLE

LACOMBE

SLIDELL

COVINGTON



Map Updated: October 2020

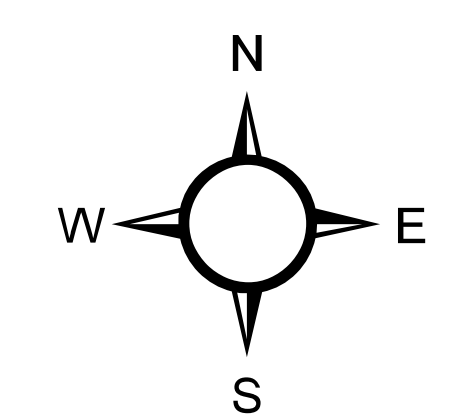
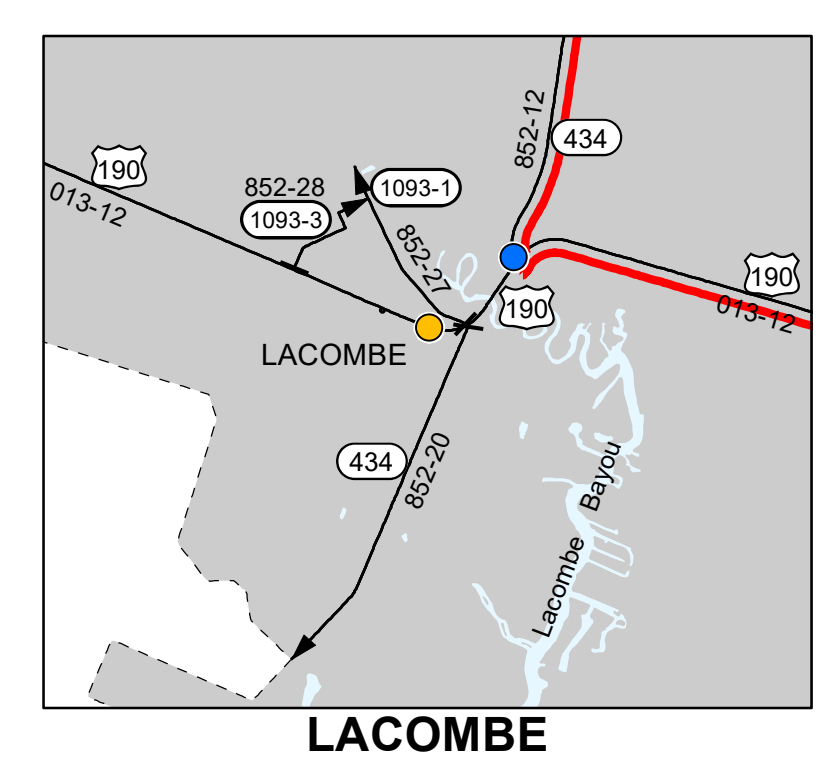
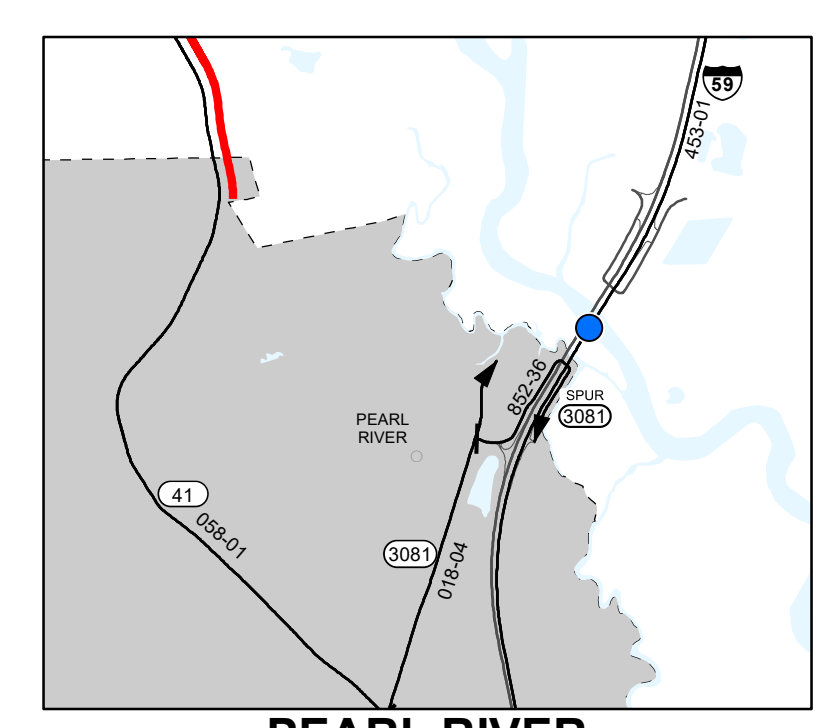
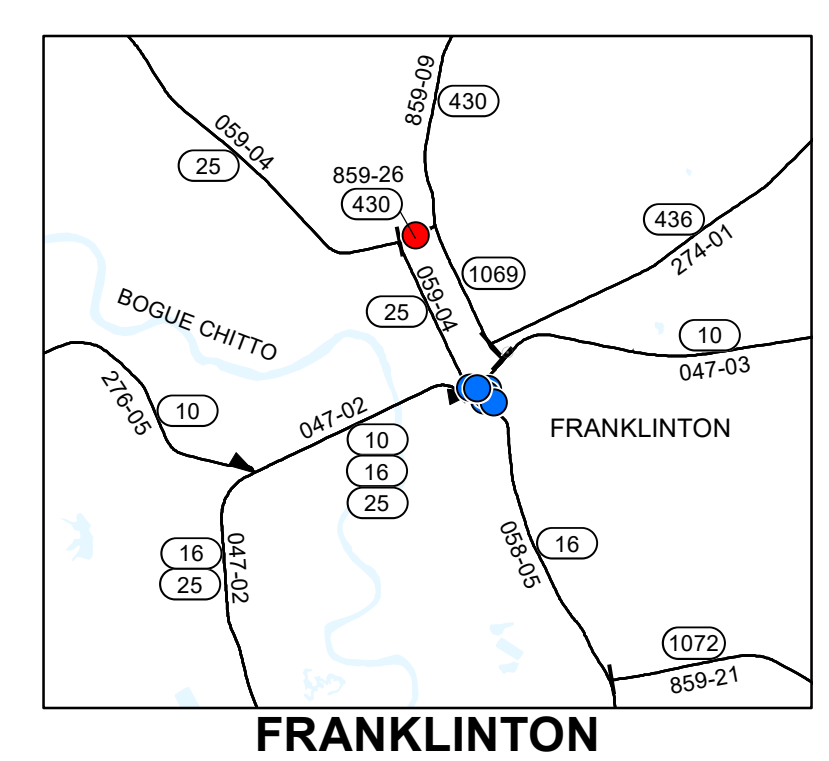

MAPS FOR LEGISLATIVE PUBLIC HEARINGS FOR SFY 2021-2022 HIGHWAY PRIORITY PROGRAM

DISTRICT 62

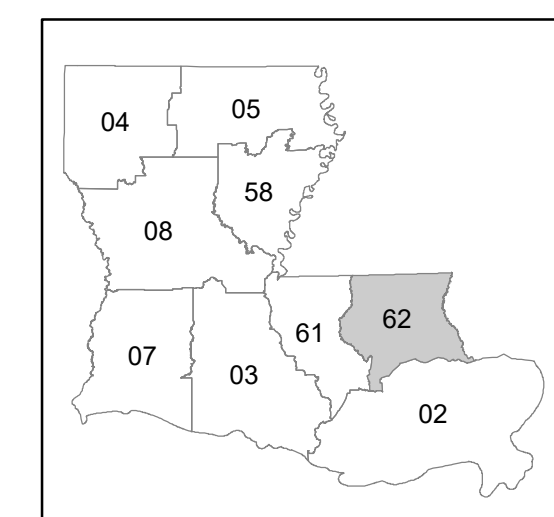
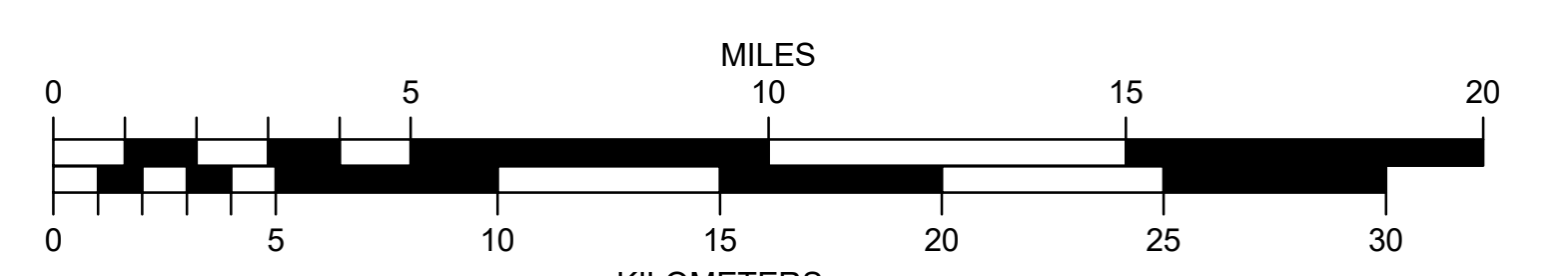

THIS MAP HAS BEEN PREPARED BY THE LOUISIANA DEPARTMENT OF TRANSPORTATION AND DEVELOPMENT OFFICE OF MILITARY PLANNING CARTOGRAPHY/IS UNIT IN COOPERATION WITH THE U.S. DEPARTMENT OF TRANSPORTATION FEDERAL HIGHWAY ADMINISTRATION.

PRINTED COPIES OF THIS MAP ARE AVAILABLE FOR PUBLIC USE AT A NOMINAL COST. PLEASE SEE THE FOLLOWING CONTACT INFORMATION:

DEPARTMENT OF TRANSPORTATION AND DEVELOPMENT
GENERAL FILES - MAP SALES
P.O. BOX 14245
BATON ROUGE, LA 70804-8245
(225) 378-1107

PROJECTION: NAD_1983_UTM_Zone_15N
Transverse Mercator
False Easting: 500000.000000
False Northing: 0.000000
Central Meridian: -91.000000
Scale Factor: 0.999600
Latitude Of Origin: 0.000000
HORIZONTAL DATUM: NORTH AMERICAN DATUM OF 1983