

Pavement Preservation

Overlay Example

STANDARD PLANS TO BE USED ON THIS PROJECT

STANDARD	REV. DATE
DW-04	9-16-82
EC-01	10-01-08
HS-03	1-03-03
MS-01	2-18-03
PA-01	1-21-03
GR-200	1-28-03
GR-202	1-28-03

STATE OF LOUISIANA
DEPARTMENT OF TRANSPORTATION

PLANS OF PROPOSED
STATE HIGHWAY

F.A.P. NO. 2508(502)
STATE PROJECT NO. 023-05-0047
EDGE OF CROSSOVER TO JACKSON PARISH LINE
AND
STATE PROJECT NO. 023-06-0065
WINN PARISH LINE TO JONESBORO
WINN AND JACKSON PARISHES
US 167

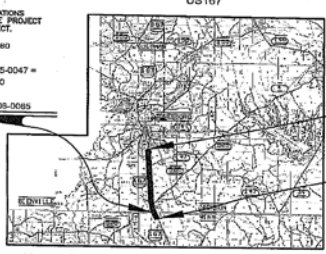



E. Hunter Lancaster
11/2/10
CIVIL ENGINEERING

THE 2008 LOUISIANA DOTD STANDARD SPECIFICATIONS FOR ROADS AND BRIDGES, AS AMENDED BY THE PROJECT SPECIFICATIONS, SHALL GOVERN ON THIS PROJECT.

C.S. LOG MILE 16.980
STA. 11+40
END S.P. NO. 023-05-0047 =
C.S. LOG MILE 0.000
STA. 19+00
BEG. S.P. NO. 023-06-0065

C.S. LOG MILE 4.700
STA. 261+35
END S.P. NO. 023-05-0055

C.S. LOG MILE 16.950
STA. 19+00
BEG. S.P. NO. 023-05-0047

TRAFFIC DATA

2009 A.D.T. = 6,305
2016 A.D.T. = 7,752
D = 53.0%
K = 10.0%
T = 16.6%

TYPE OF CONSTRUCTION: PAVEMENT PATCHING, COLD PLANE OVERLAY AND GUARDRAIL REPAIR/REPLACEMENT

RECOMMENDED FOR APPROVAL

Marshall Kell
PROGRAM DELIVERY DESIGN ENGINEER

[Signature]
DISTRICT ADMINISTRATOR

Ronald L. Brown
CHIEF ENGINEER

6-25-10
DATE

NO.	DATE	REVISIONS	DATE	RECOMMENDED	DATE	APPROVED
1	8-17-10	All sheets	8-18-10	<i>[Signature]</i>	8-19-10	<i>[Signature]</i>
2	7-29-10	All sheets	7-29-10	<i>[Signature]</i>	7-30-10	<i>[Signature]</i>

1-1

1-2

INDEX TO SHEETS

- 1 TITLE SHEET
- 2 INDEX TO SHEETS
- 2a-2d SUMMARY OF ESTIMATED QUANTITIES (GRAND TOTAL)
- 3 LIMITS OF PROJECT & REFERENCE POINTS
- 4 R.A.P. STOCKPILE MAP
- 5-7 GENERAL AND CONSTRUCTION NOTES
- 8-14a TYPICAL SECTIONS & DETAILS
- 15-26 SUMMARY SHEETS
- 27 SUMMARY OF ESTIMATED QUANTITIES FOR S.P. 023-05-0047
- 28-30 SUMMARY OF ESTIMATED QUANTITIES FOR S.P. 023-06-0065
- 31-43 GUARD RAIL QUANTITIES & DETAILS
- 44-49 TRAFFIC CONTROL & SIGNING DETAILS
- 50-55 DISTRICT LAB BORINGS FOR PROJECTS

NO.	DATE	REVISIONS	DATE	RECOMMENDED	DATE	APPROVED
1	8-17-10	All sheets	8-18-10	<i>[Signature]</i>	8-19-10	<i>[Signature]</i>
2	7-29-10	All sheets	7-29-10	<i>[Signature]</i>	7-30-10	<i>[Signature]</i>

WINN & JACKSON

STATE PROJECT NO. 023-05-0047

STATE PROJECT NO. 023-06-0065

INDEX TO SHEETS



S. E. HUEY CO.

Pavement Preservation

Overlay Example

8/18/2010

Summary Of Estimated Quantities

Page: 2a

Proposal ID: 023-06-0065 State Project Number: 023-05-0047 & 023-06-0065
 Federal Project Number: 2508(502)
 Proposal Description: EDGE OF CROSSOVER TO JACKSON P/L and WINN P/L TO JONESBORO

Item No.	Description	Supplemental Description	Alternate Set Member	Quantity	Units
201-01-00200	Clearing and Grubbing (Selective)	General Items (Tree Trimming)		1	LUMP
202-01-00100	Removal of Structures and Obstructions			1.000	LUMP
202-02-14600	Removal of Guard Rail			2,874.000	LNFT
203-01-00100	General Excavation			97.000	CUYD
203-04-00300	Nonplastic Embankment (Stone)			97.000	CUYD
203-07-00100	Borrow (Vehicular Measurement)			2,262.000	CUYD
203-08-00100	Geotextile Fabric			100.000	SQYD
401-02-00100	Aggregate Surface Course (Adjusted Vehicular Measurement)			20.000	CUYD
502-01-00100	Superpave Asphaltic Concrete			19,344.800	TON
502-01-00200	Superpave Asphaltic Concrete, Drives, Turnouts and Miscellaneous			1,413.300	TON
507-01-00100	Asphaltic Material (CRS-2P Emulsion)			47,998.000	GAL
507-02-00200	Aggregate (S2)			70,563.000	SQYD
507-02-00300	Aggregate (S3)			70,563.000	SQYD
508-01-00100	Cold Fining Asphaltic Pavement			72,821.000	SQYD

Notes:
 Rev. 1 - 7/29/2010 - Added, deleted, & revised items; added S.P. 023-05-0047
 Rev. 2 - 8/17/2010 - Added, deleted, & revised item qty.

8/18/2010

Summary Of Estimated Quantities

Page: 2b

Proposal ID: 023-06-0065 State Project Number: 023-05-0047 & 023-06-0065
 Federal Project Number: 2508(502)
 Proposal Description: EDGE OF CROSSOVER TO JACKSON P/L and WINN P/L TO JONESBORO

Item No.	Description	Supplemental Description	Alternate Set Member	Quantity	Units
509-02-00100	Contractor Retained Reclaimed Asphaltic Pavement			-3,035.000	CUYD
510-01-00300	Pavement Patching (18" Minimum Thickness)			3,114.000	SQYD
510-01-00400	Pavement Patching (24" Minimum Thickness)			876.000	SQYD
510-03-00100	Pavement Joint Repair			503.400	TON
704-01-01000	Guard Rail (Single Thrie Beam) (3'-1 1/2" post spacing)			612.500	LNFT
704-03-00100	Blocked Out Guard Rail			3,093.800	LNFT
704-08-00200	Guard Rail Anchor Sections (Trailing End) (Single Thrie Beams)			86.800	LNFT
704-11-00100	Guard Rail End Treatment (Flared)			11.000	EACH
713-01-00100	Temporary Signs and Barrioles			1.000	LUMP
713-02-00300	Temporary Pavement Markings (8" Width)			493.000	LNFT
713-03-01000	Temporary Pavement Markings (Broken Line) (4" Width) (4' Length)			14,351	MILE
713-03-02000	Temporary Pavement Markings (Broken Line) (4" Width) (10' Length)			19.148	MILE
713-04-01000	Temporary Pavement Markings (Solid Line) (4" Width)			38.296	MILE
713-05-00100	Temporary Pavement Legends & Symbols (Arrow)			4.000	EACH

Notes:
 Rev. 1 - 7/29/2010 - Added, deleted, & revised items; added S.P. 023-05-0047
 Rev. 2 - 8/17/2010 - Added, deleted, & revised item qty.

Pavement Preservation

Overlay Example

8/18/2010

Summary Of Estimated Quantities

Page: 2c

Proposal ID: 023-06-0065 State Project Number: 023-05-0047 & 023-06-0065
 Federal Project Number: 2508(502)

Proposal Description: EDGE OF CROSSOVER TO JACKSON P/L and WINN P/L TO JONESBORO

Item No.	Description	Supplemental Description	Alternate Set Member	Quantity	Units
713-05-00300	Temporary Pavement Legends & Symbols (ONLY)			4.000	EACH
713-06-00200	Temporary ReflectORIZED Raised Pavement Markers (Tabs)			1,350,000	EACH
716-01-00100	Mulch (Vegetative)			16,500	TON
717-01-00100	Seeding			564,000	LB
718-01-00100	Fertilizer			9,230,000	LB
727-01-00100	Mobilization			1.000	LUMP
729-16-00300	Object Marker Assembly (Type 3)			22.000	EACH
731-02-00100	ReflectORIZED Raised Pavement Markers			721.000	EACH
732-01-01040	Plastic Pavement Striping (8" Width) (Thermoplastic 90 ml)			493.000	LNFT
732-01-01080	Plastic Pavement Striping (24" Width) (Thermoplastic 90 ml)			670.000	LNFT
732-02-02000	Plastic Pavement Striping (Solid Line) (4" Width) (Thermoplastic 90 ml)			9.574	MILE
732-03-02000	Plastic Pavement Striping (Broken Line) (4" Width) (Thermoplastic 90 ml)			4.787	MILE
732-04-01080	Plastic Pavement Legends and Symbols (Arrow - Left Turn)			4.000	EACH

Notes:
 Rev. 1 - 7/29/2010 - Added, deleted, & revised items; added S.P. 023-05-0047
 Rev. 2 - 8/17/2010 - Added, deleted, & revised item qty.

8/18/2010

Summary Of Estimated Quantities

Page: 2d

Proposal ID: 023-06-0065 State Project Number: 023-05-0047 & 023-06-0065
 Federal Project Number: 2508(502)

Proposal Description: EDGE OF CROSSOVER TO JACKSON P/L and WINN P/L TO JONESBORO

Item No.	Description	Supplemental Description	Alternate Set Member	Quantity	Units
732-04-15020	Plastic Pavement Legends and Symbols (ONLY)			4.000	EACH
735-01-00100	Mailboxes			1.000	EACH
735-02-00100	Mailbox Supports (Single)			1.000	EACH
740-01-00100	Construction Layout			1.000	LUMP
NS-500-00220	Sawing and Sealing Longitudinal Joints in Asphaltic Concrete Overlay			9,109.000	LNFT
NS-500-00240	Sawing and Sealing Transverse Joints in Asphaltic Concrete Overlay			5,160.000	LNFT
NS-500-00290	Sawcuts in Asphaltic Concrete Lifts			14,269.000	LNFT
NS-500-00340	Saw Cutting Asphaltic Concrete Pavement			116,514.000	INLF
NS-500-00360	Saw Cutting Asphaltic Concrete Pavement Over Portland Cement Concrete Composite Pavement			36,552.000	INLF
NS-502-00001	Milling Concrete Pavement			1,662.700	SQYD
NS-724-00002	Rumble Strips (Shoulder Ground-In)			9.800	MILE

Notes:
 Rev. 1 - 7/29/2010 - Added, deleted, & revised items; added S.P. 023-05-0047
 Rev. 2 - 8/17/2010 - Added, deleted, & revised item qty.

Pavement Preservation

Overlay Example

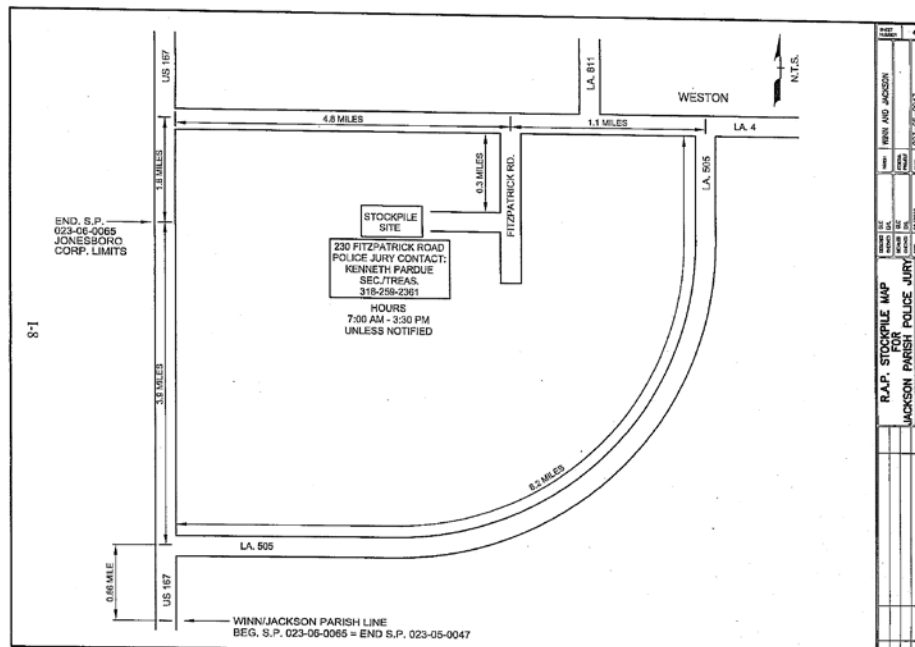
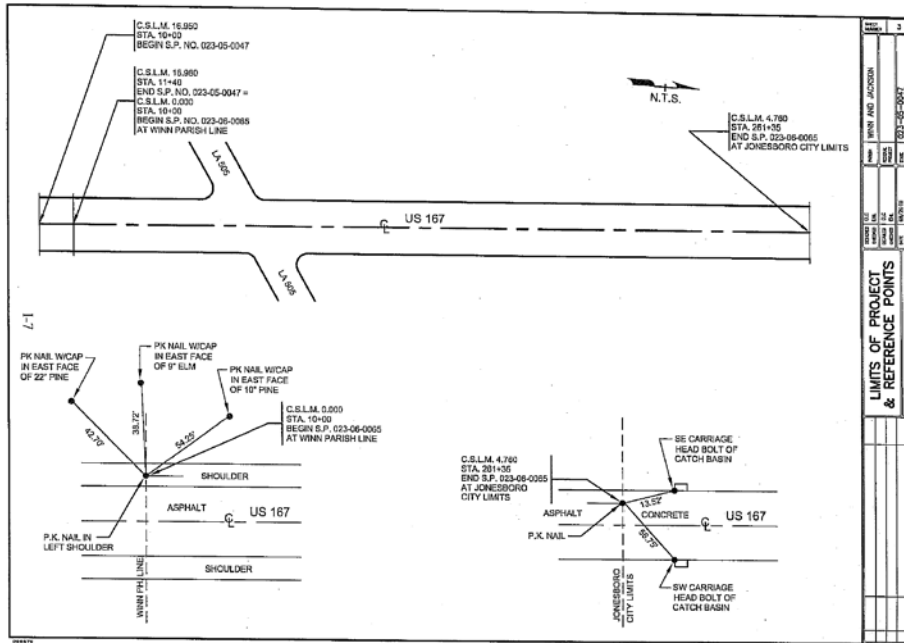

Pavement Preservation

Overlay Example

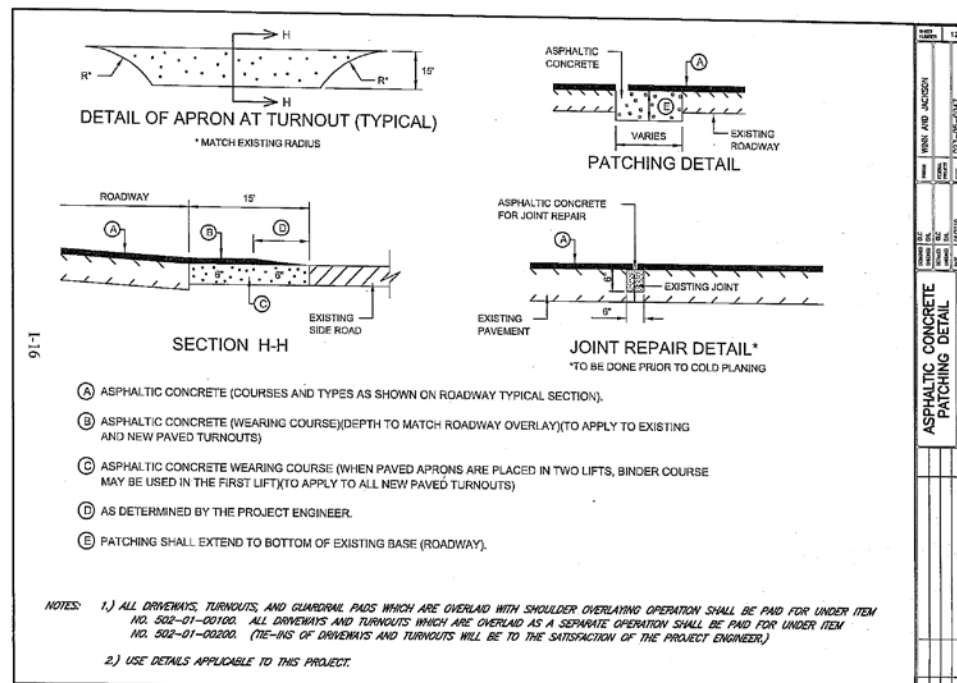
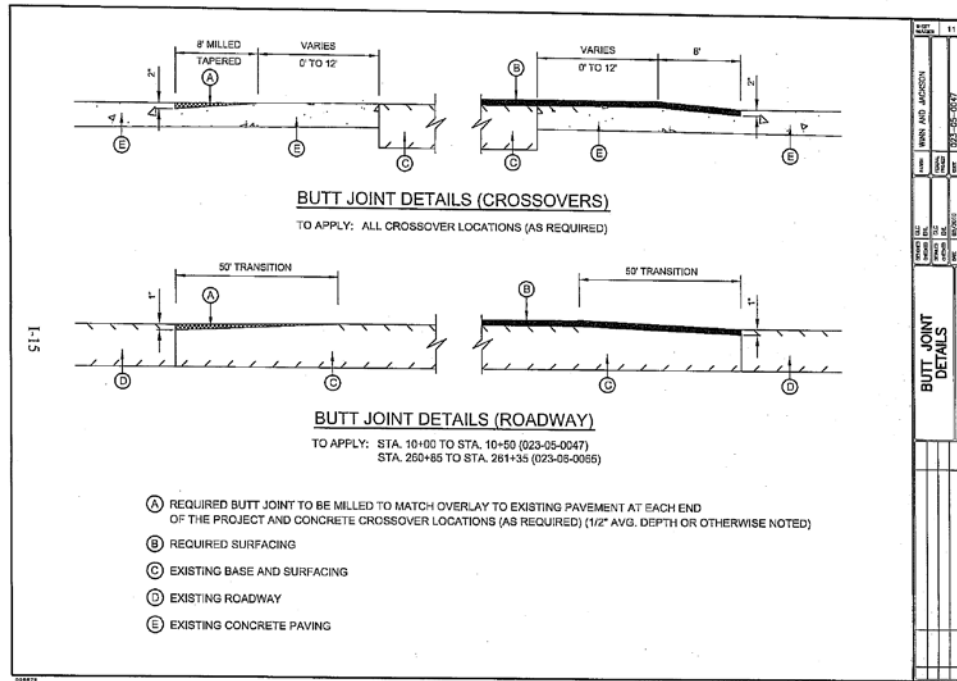

Pavement Preservation

Overlay Example

SHOULDER SURFACING							502-01-00100	
STATION	STATION	DESCRIPTION	LENGTH	WIDTH	AREA	SUPERPAVE ASPHALTIC CONCRETE WEARING COURSE (2" DEPTH)	TON	SHEET NUMBER
			FEET	FEET	SQ. YDS.			
023-05-0047								
10+00	11+40	SHOULDER (L.T.)	140	8	124.4		13.7	16
10+00	11+40	SHOULDER (RT.)	140	8	124.4		13.7	
SUBTOTAL 023-05-0047								27.4
023-06-0065								
10+00	252+35	SHOULDER (L.T.)	24235	8	21542.2		2962.1	17
10+00	252+35	SHOULDER (RT.)	24235	8	21542.2		2962.1	
252+35	281+35	SHOULDER (L.T.)	900	6.0 (AVG.)	600.0		96.0	
252+35	291+35	SHOULDER (RT.)	900	12.8 (AVG.)	1280.0		140.8	
SUBTOTAL 023-06-0065								6131.0
GRAND TOTAL								6158.4



* TYPICAL SECTION INDICATES 2" ASPHALTIC CONCRETE WEARING COURSE. HOWEVER, FOR ESTIMATING PURPOSES ONLY, 2 1/2" IS USED TO ACCOUNT FOR DIFFERENTIAL SETTLEMENT.

ASPHALTIC CONCRETE		502-01-00200	
DESCRIPTION	SUPERPAVE ASPHALTIC CONCRETE, DRIVES, TURNOUTS AND MISCELLANEOUS		
	TON		
APRONS/DRIVES	35.5		
TURNOUTS	262.5		
GUARD RAIL PADS (EXISTING)	247.0		
GUARD RAIL PADS (ADDITIONAL QUANTITY REQUIRED FOR UPGRADING TO CURRENT DESIGN STANDARDS)	835.4		
TOTAL	1413.3		

Pavement Preservation

Overlay Example

ASPHALTIC SURFACE TREATMENT (TYPE E)										
STATION	STATION	DESCRIPTION	LENGTH	WIDTH	AREA	307-01-00100	507-02-00200	507-02-00300	FEET INCHES	18
						ASPHALTIC MATERIAL (CRS-2P EMULSION)	AGGREGATE (S2)	AGGREGATE (S3)		
			FEET	FEET	SQ. YDS.	GAL.	SQ. YD.	SQ. YD.		
023-05-0047										
10+00	11+40	ROADWAY - 1st COURSE	140.0	24	373	146	373			
10+00	11+40	ROADWAY - 2nd COURSE	140.0	24	373	108	373	373		
SUBTOTAL 023-05-0047						253	373	373		
023-05-0065										
10+00	252+35	ROADWAY - 1st COURSE	24235.0	24	64627	25205	64627			
10+00	252+35	ROADWAY - 2nd COURSE	24235.0	24	64627	18742		64627		
252+35	251+35	ROADWAY - 1st COURSE	900.0	35.00 (AVG.)	3500	1365	3500			
252+35	251+35	ROADWAY - 2nd COURSE	900.0	35.00 (AVG.)	3500	1015		3500		
11+62	14+40	TURN LANE - 1st COURSE	278.0	12	371	145	371			
14+40	16+20	TURN LANE - 1st COURSE	180.0	6.00 (AVG.)	120	47	120			
11+62	14+40	TURN LANE - 2nd COURSE	278.0	12	371	108		371		
14+40	16+20	TURN LANE - 2nd COURSE	180.0	6.00 (AVG.)	120	35		120		
45+70	47+20	TURN LANE - 1st COURSE	150.0	12	200	78	200			
47+20	46+85	TURN LANE - 1st COURSE	165.0	6.00 (AVG.)	110	43	110			
45+70	47+20	TURN LANE - 2nd COURSE	150.0	12	200	58		200		
47+20	46+85	TURN LANE - 2nd COURSE	165.0	6.00 (AVG.)	110	32		110		
182+50	185+25	TURN LANE - 1st COURSE	276.0	12	368	144	368			
185+25	187+58	TURN LANE - 1st COURSE	232.0	6.00 (AVG.)	155	60	155			
182+50	185+25	TURN LANE - 2nd COURSE	276.0	12	368	107		368		
185+25	187+58	TURN LANE - 2nd COURSE	232.0	6.00 (AVG.)	155	45		155		
212+72	215+51	TURN LANE - 1st COURSE	279.0	12	372	145	372			
212+51	218+32	TURN LANE - 1st COURSE	581.0	6.00 (AVG.)	367	151	367			
212+72	215+51	TURN LANE - 2nd COURSE	279.0	12	372	108		372		
212+51	218+32	TURN LANE - 2nd COURSE	581.0	6.00 (AVG.)	367	112		367		
SUBTOTAL 023-05-0065						47745	70210	70210		
GRAND TOTAL						47588	70563	70563		

WIRTH & JACOBSON	18
STATE OF KANSAS	COUNTY OF
CITY OF	DISTRICT
PROJECT NO.	DATE
DRAWN BY	CHECKED BY
SCALE	SHEET NO.

S. E. HUEY CO.

Pavement Preservation

Overlay Example

COLD PLANING

STATION	STATION	DESCRIPTION	LENGTH	WIDTH	509-01-00100	NS-602-00001
					COLD PLANING ASPHALTIC PAVEMENT (2" DEPTH)	NS-MILLING CONCRETE PAVEMENT (2" DEPTH)
					SQ. YD.	SQ. YD.
FEET	FEET					
023-06-0065						
196+41	166+51	CROSS OVER TIE-IN	310	8	276	
209+70	212+72	CROSS OVER TIE-IN	302	8	268	
212+72	215+51	CROSS OVER TURN LANE	279	12		372.0
215+51	218+32	CROSS OVER TURN LANE	281	6 (AVG.)		187.3
221+14	224+24	CROSS OVER TIE-IN	310	8	276	
229+05	231+39	CROSS OVER TIE-IN	194	8	137	
SUBTOTAL 023-06-0065 THIS SHEET					957	593.3
GRAND TOTAL 023-06-0065					72324	1882.7

1-20

JACKSON

023-06-0065

SHEET 21

PAVEMENT PATCHING

STATION	STATION	DESCRIPTION	LENGTH	WIDTH	510-01-00300	510-01-00400	NS-500-00340	NS-500-00380
					PAVEMENT PATCHING (18" MINIMUM THICKNESS)	PAVEMENT PATCHING (24" MINIMUM THICKNESS)	SAW CUTTING ASPHALTIC CONCRETE PAVEMENT	SAW CUTTING ASPHALTIC CONCRETE PAVEMENT OVER PORTLAND CEMENT SEMIPRISTE PAVEMENT
					SQ. YD.	SQ. YD.	INFT	INFT
14+22	16+92	SHOULDER - RT.	270	3.5	105		9646	
17+66	17+96	SHOULDER - RT.	20	2.5	5		810	
18+00	18+99	SHOULDER - RT.	99	3.0	20		2232	
24+95	29+33	SHOULDER - RT.	138	8.0	123		2772	
28+42	32+05	SHOULDER - LT.	363	8.0	323		6822	
30+29	33+58	SHOULDER - RT.	329	8.0	292		6210	
37+75	38+93	SHOULDER - LT.	118	2.5	33		4338	
38+97	40+63	SHOULDER - LT.	166	4.5	83		6138	
39+24	39+33	ROADWAY-RT.	9	12.0		12		1006
50+53	50+58	ROADWAY	5	24.0		13		1362
50+91	51+15	ROADWAY	24	24.0		64		2304
50+91	51+15	SHOULDER - RT.	24	5.0	21		720	
53+90	54+15	ROADWAY	19	24.0		51		2064
57+88	58+10	ROADWAY	22	24.0		99		2208
69+91	70+04	SHOULDER - RT.	613	8.0	546		11322	
88+86	89+00	ROADWAY-RT.	14	12.0		19		1248
90+47	90+58	ROADWAY	11	24.0		29		1880
97+91	99+03	ROADWAY - RT.	12	12.0		16		1152
101+62	101+70	ROADWAY - RT.	18	12.0		24		1440
103+12	103+32	ROADWAY	20	24.0		53		2112
103+28	104+36	SHOULDER - RT.	107	8.0	95		2214	
TOTAL THIS SHEET					1648	340	53424	16608

1-27

JACKSON

023-06-0065

SHEET 22

Pavement Preservation

Overlay Example

8/18/2010

Summary Of Estimated Quantities

Project ID: 023-06-0065
State Project Number: 023-06-0066
Page: 28

Federal Project Number: 2506(502)

Project Description: WINN PARISH LINE TO JONESBORO

Item No.	Description	Supplemental Description	Alternate Set Member	Quantity	Units
General Items					
201-01-00200	Clearing and Grubbing (Selective)	(Tree Trimming)		(3,000)	ACRE
202-01-00100	Removal of Structures and Obstructions			1,000	LUMP
202-02-14500	Removal of Guard Rail			2,874,000	LNFT
203-01-00100	General Excavation			97,000	CUYD
203-04-00300	Nonplastic Embankment (Stone)			97,000	CUYD
203-07-00100	Borrow (Vehicular Measurement)			2,262,000	CUYD
203-08-00100	Geotextile Fabric			100,000	SQYD
401-02-00100	Aggregate Surface Course (Adjusted Vehicular Measurement)			20,000	CUYD
502-01-00100	Superspave Asphaltic Concrete			19,245,500	TON
502-01-00200	Superspave Asphaltic Concrete, Drives, Turnouts and Miscellaneous			1,413,300	TON
507-01-00100	Asphaltic Material (CRS-2P Emulsion)			47,746,000	GAL
507-02-00200	Aggregate (S2)			70,210,000	SQYD
507-02-00300	Aggregate (S3)			70,210,000	SQYD
509-01-00100	Cold Placing Asphaltic Pavement			72,324,000	SQYD
509-02-00100	Contractor Retained Reclaimed Asphaltic Pavement			-3,014,000	CUYD
510-01-00300	Pavement Patching (18" Minimum Thickness)			3,114,000	SQYD
510-01-00400	Pavement Patching (24" Minimum Thickness)			876,000	SQYD
510-03-00100	Pavement Joint Repair			500,800	TON

Notes:

See bottom of proposal summary pages for applicable revision notes.

Pavement Preservation

Overlay Example

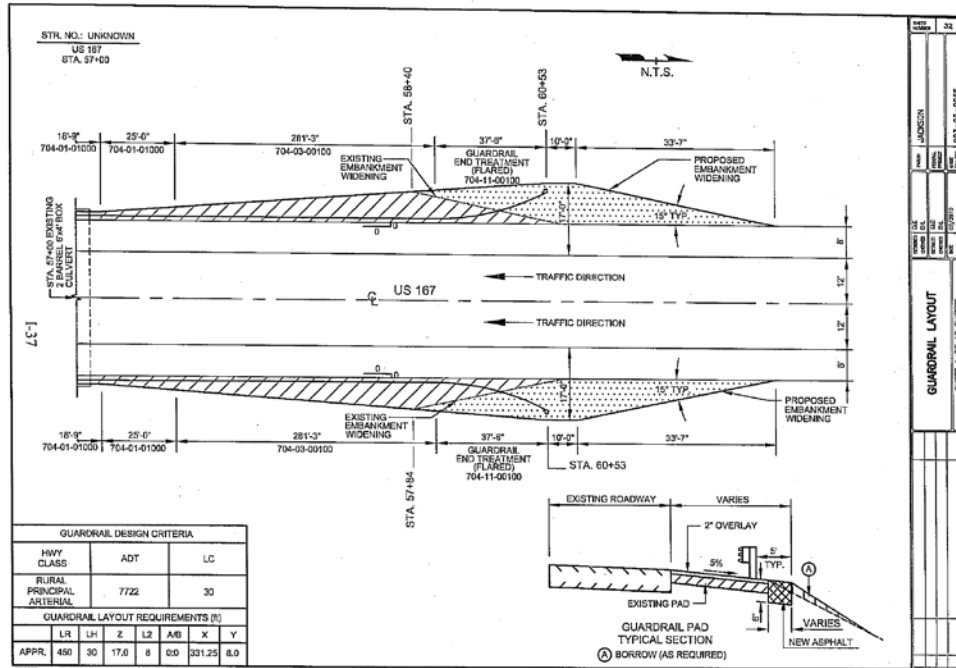

8/18/2010

Summary Of Estimated Quantities

Page: 29

Project ID: 023-06-0065 State Project Number: 023-06-0065
 Federal Project Number: 2508(S02)

Project Description: WINN PARISH LINE TO JONESBORO

Item No.	Description	Supplemental Description	Alternate Set Member	Quantity	Units
704-01-01000	Guard Rail (Single Thrie Beam) (3'-1 1/2" post spacing)			612,500	LNFT
704-03-00100	Blocked Out Guard Rail			3,093,800	LNFT
704-05-00200	Guard Rail Anchor Sections (Trailing End) (Single Thrie Beam)			68,900	LNFT
704-11-00100	Guard Rail End Treatment (Flared)			11,000	EACH
713-01-00100	Temporary Signs and Barricades			1,000	LUMP
713-02-00300	Temporary Pavement Markings (8" Width)			493,000	LNFT
713-03-01000	Temporary Pavement Markings (Broken Line) (4" Width) (4' Length)			14,281	MILE
713-03-02000	Temporary Pavement Markings (Broken Line) (4" Width) (10' Length)			19,042	MILE
713-04-01000	Temporary Pavement Markings (Solid Line) (4" Width)			38,080	MILE
713-05-00100	Temporary Pavement Legends & Symbols (Arrow)			4,000	EACH
713-05-00300	Temporary Pavement Legends & Symbols (ONLY)			4,000	EACH
713-06-00200	Temporary ReflectORIZED Raised Pavement Markers (Tabs)			1,343,000	EACH
716-01-00100	Mulch (Vegetative)			18,500	TON
717-01-00100	Seeding			554,000	LB
718-01-00100	Fertilizer			9,230,000	LB
727-01-00100	Mobilization			1,000	LUMP
728-18-00300	Object Marker Assembly (Type 3)			22,000	EACH
731-02-00100	ReflectORIZED Raised Pavement Markers			716,000	EACH

Notes:

See bottom of proposal summary pages for applicable revision notes.

Pavement Preservation

Overlay Example

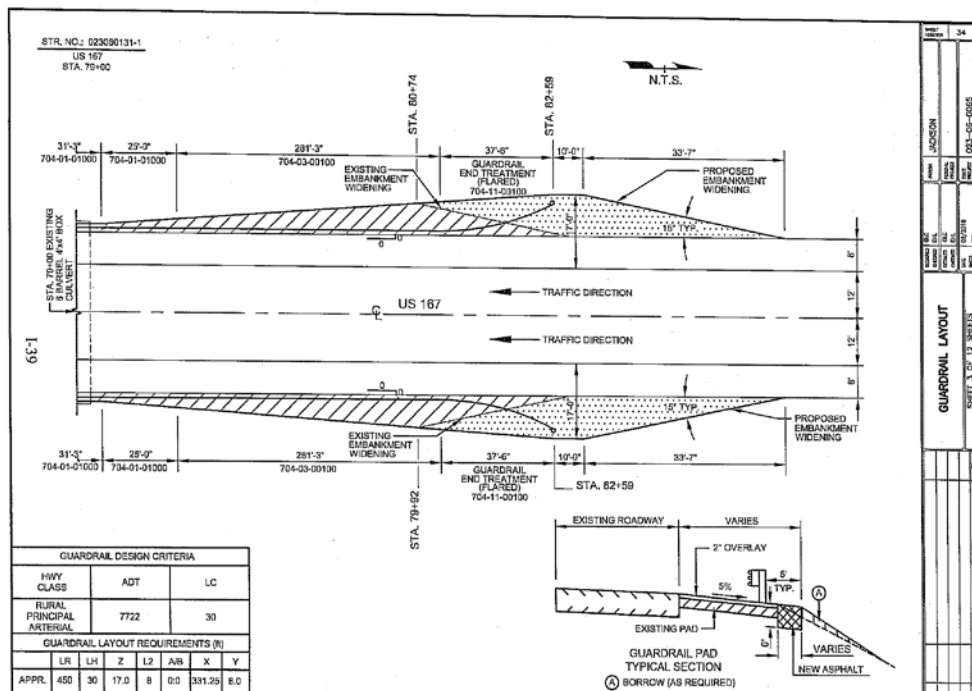
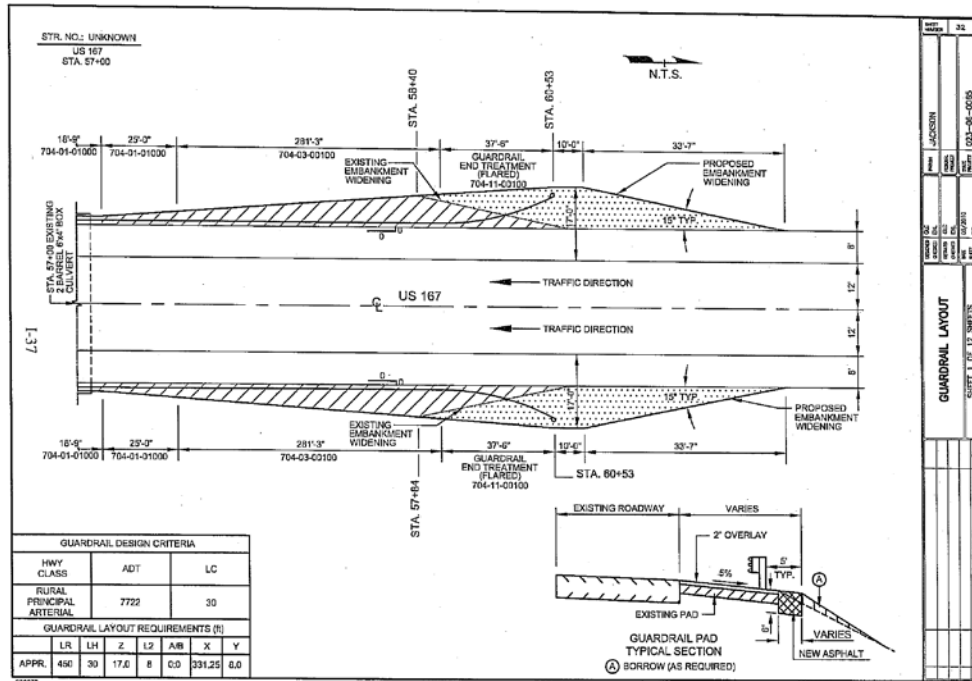

Pavement Preservation

Overlay Example

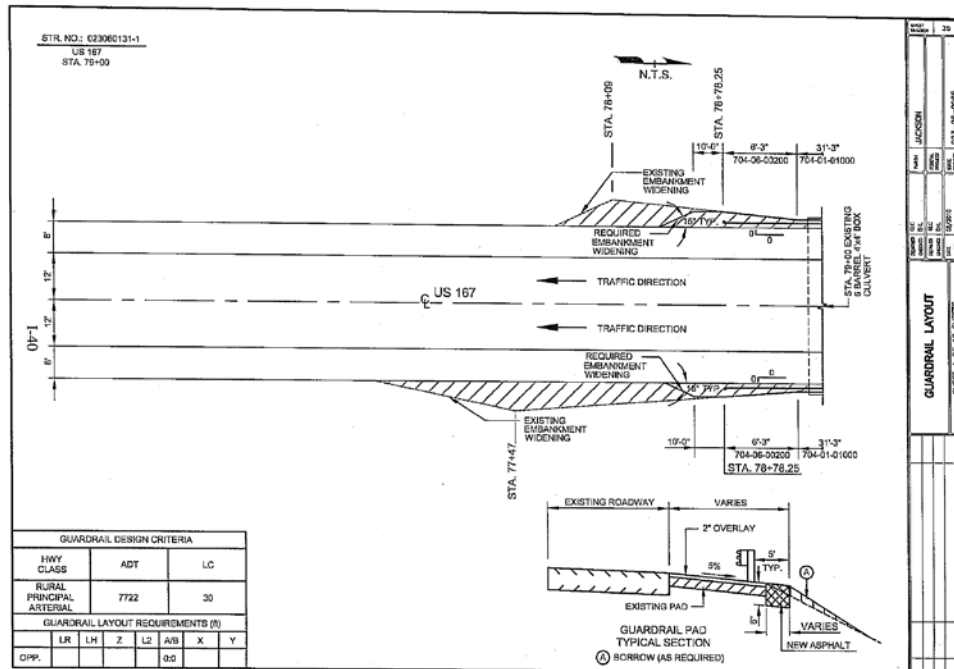
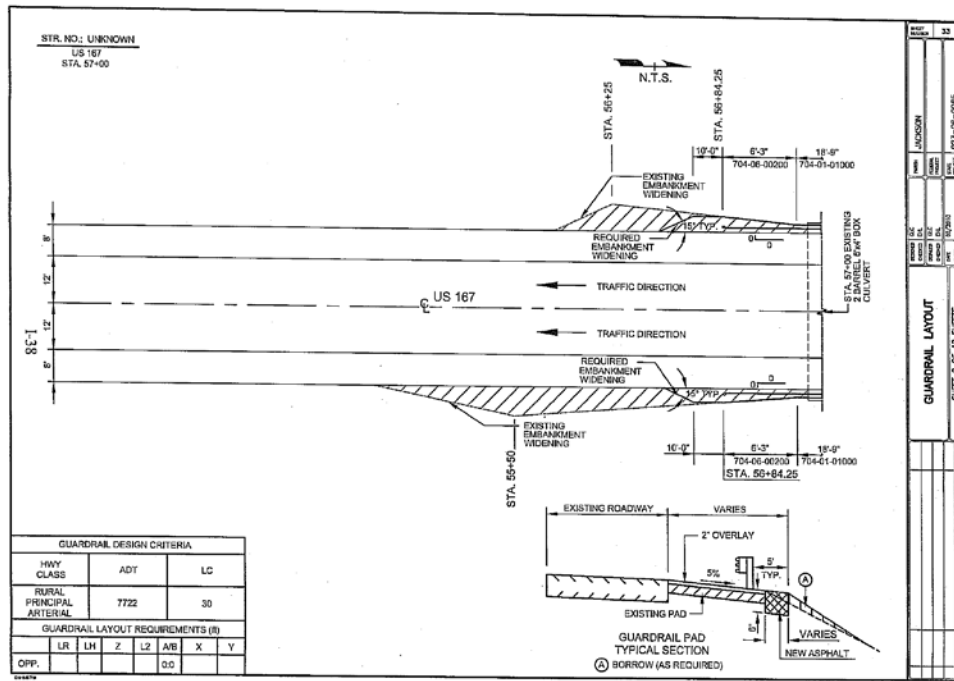

Pavement Preservation

Overlay Example

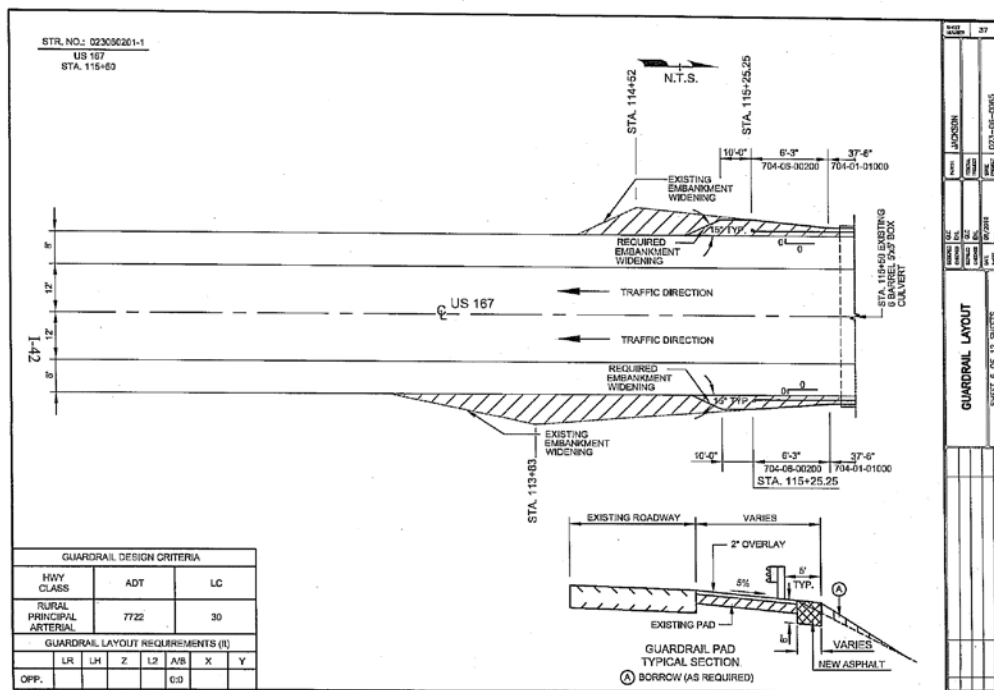
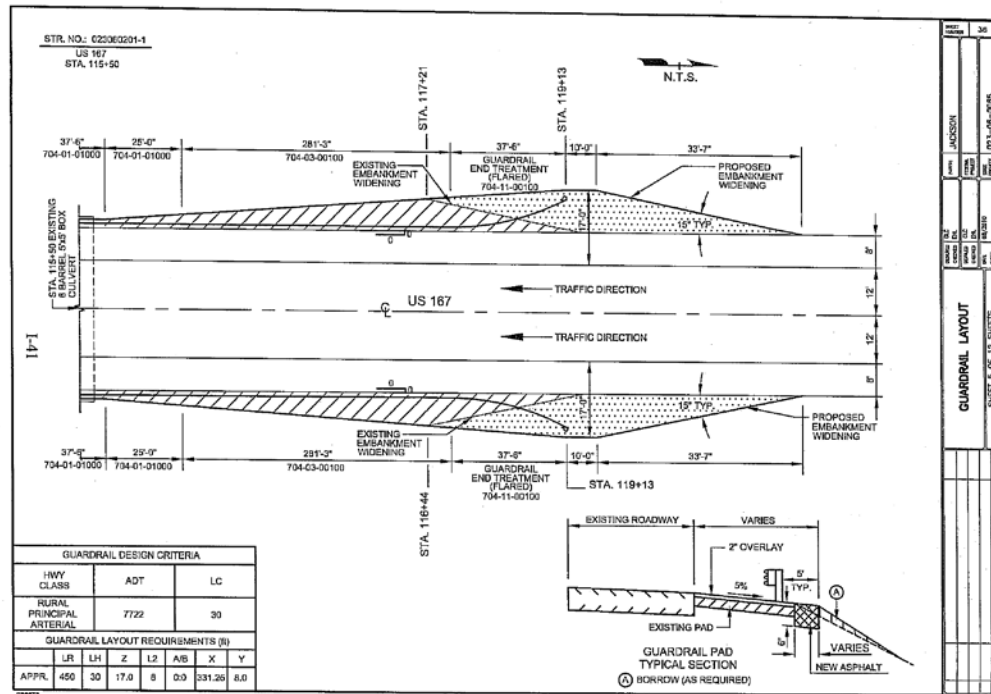

Pavement Preservation

Overlay Example

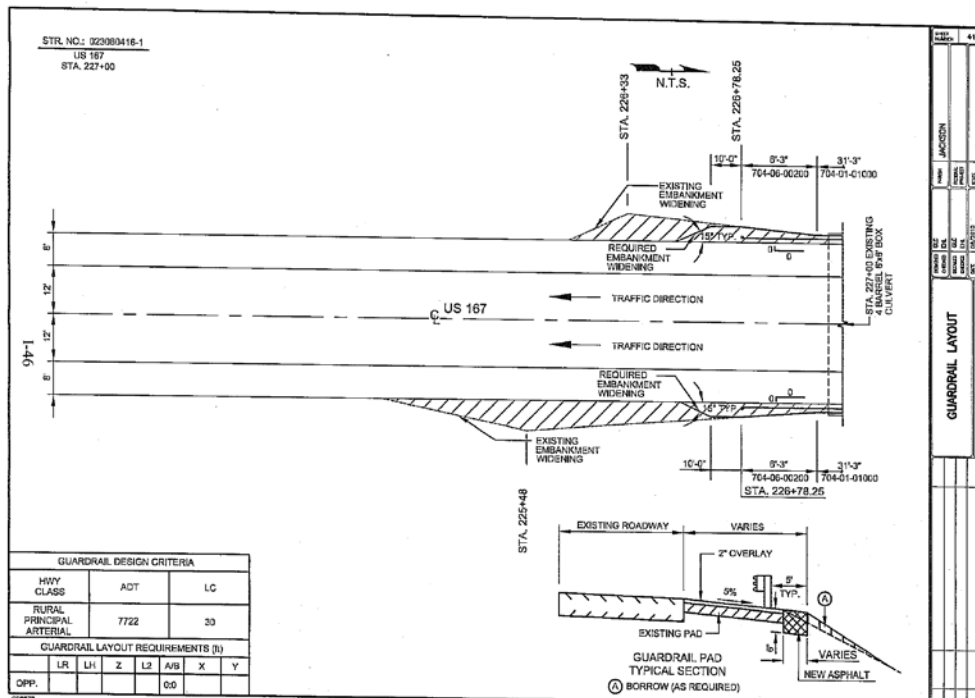
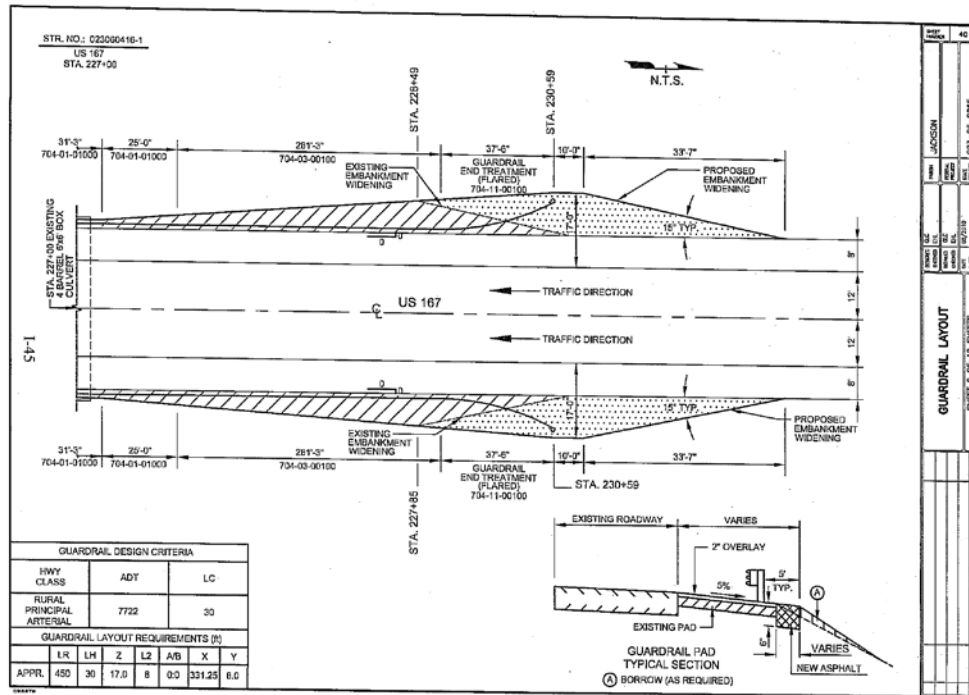

Pavement Preservation

Overlay Example

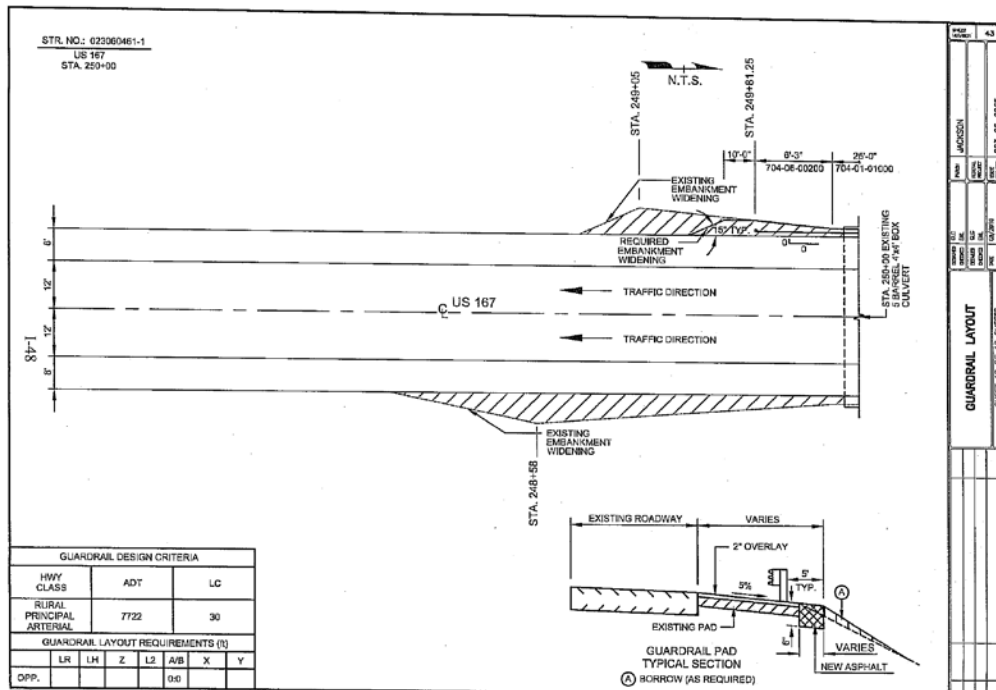
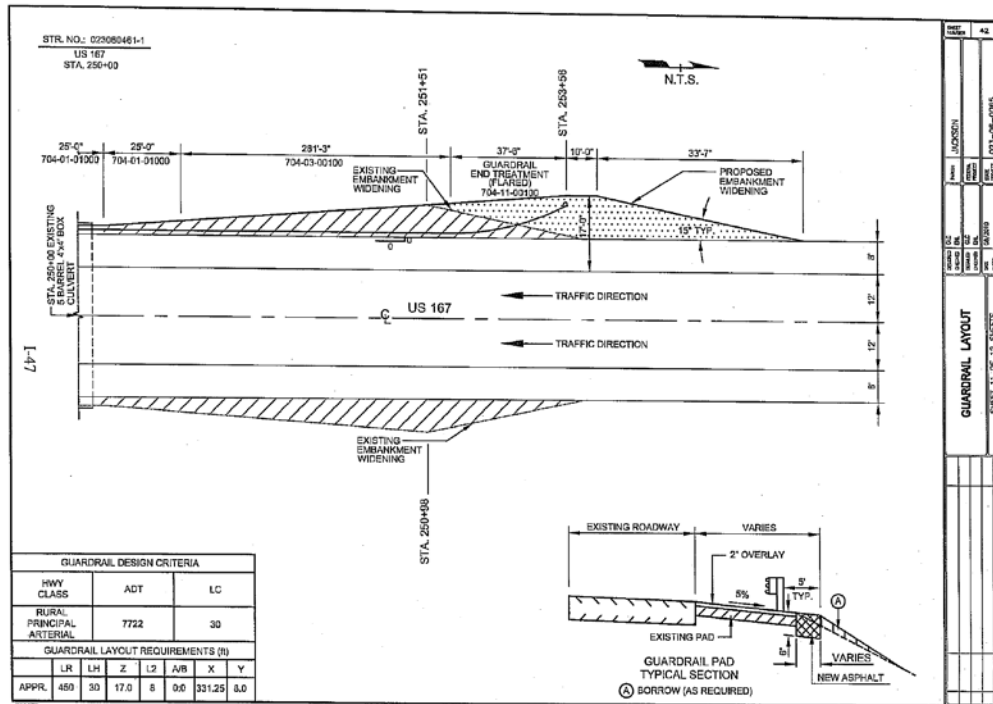

Pavement Preservation

Overlay Example

Temporary Traffic Control (TC-00, TC-01, TC-02, TC-03, TC-05, TC-15) – Found on the DOTD Standard Details website

1-55

S.P. 023-06-0065											SHEET NUMBER	50				
LOCATION STATION (FT.)	ROADWAY				SHOULDER						DISTRICT	PROJECT				
	SURFACE		BASE		SUBBASE		SURFACE		BASE				SUBBASE			
	TYPE	(")	TYPE	(")	TYPE	(")	TYPE	(")	TYPE	(")	TYPE	(")	TYPE	(")	TYPE	(")
15+00	18 FT. LT CL						HM	2.50	S-1, SC HP	8.00	A-6(2), LL-28 Pl-12					
20+00	8 FT. LT CL	HM	10.00	PCC												
	18 FT. RT CL						HM	2.00	(S-1)	7.00	(S-2)					
25+00	18 FT. LT CL						HM	2.00	(S-1)	5.00	(S-2)					
30+00	18 FT. RT CL						HM	3.50	(S-1)	8.00	(S-2)					
35+00	18 FT. LT CL						HM	2.50	(S-1)	5.00	(S-2)					
40+00	8 FT. RT CL	HM	10.00	PCC												
	18 FT. RT CL						HM	2.00	(S-1)	5.00	(S-2)					
45+00	18 FT. LT CL						HM	2.50	S-3, SC HP	7.00	A-6(1), LL-24 Pl-7					
50+00	18 FT. RT CL						HM	2.00	(S-3)	8.00	(S-4)					
55+00	18 FT. LT CL						HM	2.00	(S-4)	8.00	(S-4)					
60+00	8 FT. LT CL	HM	10.50	PCC												

KEY:	HM	ASPHALTIC CONCRETE
	SC	SOIL CEMENT
	PCC	PORTLAND CEMENT CONCRETE
	SCG	SAND CLAY GRAVEL
	ST	SURFACE TREATMENT
	CL	CENTERLINE

REMARKS:	ALL BORINGS ON SHOULDER 2' IN DEPTH
	HIGH MOISTURE IN SHOULDER SUBBASE @ 20+00.

SUBMITTED BY:	CARL K. HARWELL	DATE BORED:	1/21/2009	LAB ENGINEER	<i>Olis E. Peterson</i>
---------------	-----------------	-------------	-----------	--------------	-------------------------

STATE OF LOUISIANA

Olis E. Peterson, Jr.

REG. No. 13305

PROFESSIONAL ENGINEER

1-29-09

Pavement Preservation

Overlay Example

1-56

S.P. 023-06-0065

LOCATION STATION (FT.)	ROADWAY						SHOULDER					
	SURFACE		BASE		SUBBASE		SURFACE		BASE		SUBBASE	
	TYPE	(')	TYPE	(')	TYPE	(inches)	TYPE	(')	TYPE	(')	TYPE	(inches)
80+00 16 FT. RT. CL.							HM	2.00	(S-4)			
85+00 16 FT. LT. CL.							HM	1.50	(S-3)	7.00	(S-4)	
90+00 16 FT. RT. CL.							HM	2.00	S-7, CL, LM A-6(2), LL-34 S-10, LT, BTY CL S-11			
95+00 16 FT. LT. CL.							HM	2.00	S-8, SC NP	7.00	(S-5)	
100+00 8 FT. RT. CL.	HM	12.00	PCC									
105+00 16 FT. RT. CL.							HM	2.00	(S-4)	5.00	(S-5)	
110+00 16 FT. LT. CL.							HM	2.50	(S-6)	7.00	(S-6)	
115+00 16 FT. RT. CL.							HM	2.00	(S-6)	4.00	(S-4)	
120+00 8 FT. LT. CL.	HM	10.50	PCC									
125+00 16 FT. RT. CL.							HM	3.00	(S-4)	7.00	S-7, CL, LM A-6(2), LL-31 S-11	
130+00 16 FT. LT. CL.							HM	1.50	(S-7)			
135+00 16 FT. RT. CL.							HM	1.50	S-8, SC NP	7.00	(S-7)	

KEY:
 HM ASPHALTIC CONCRETE
 SC SOIL CEMENT
 PCC PORTLAND CEMENT CONCRETE
 SCG SAND CLAY GRAVEL
 ST SURFACE TREATMENT
 CL CENTERLINE

REMARKS: ALL BORINGS ON SHOULDERS 2' IN DEPTH
 HIGH PI MATERIAL IN SHOULDER SUBGRADE STA. 80+00 - 100+00

STATE OF LOUISIANA
 PROFESSIONAL ENGINEER
 Otis E. Peterson, Jr.
 REG. No. 13306
 DISTRICT OF BOSSON
 IN
 Otis Peterson 1-29-09

SUBMITTED BY: CARL K. HARWELL DATE BORED: 1/21/2009 LAB ENGINEER

1-57

S.P. 023-06-0065

LOCATION STATION (FT.)	ROADWAY						SHOULDER					
	SURFACE		BASE		SUBBASE		SURFACE		BASE		SUBBASE	
	TYPE	(')	TYPE	(')	TYPE	(inches)	TYPE	(')	TYPE	(')	TYPE	(inches)
117+00 16 FT. LT. CL.							HM	1.50	(S-8)	7.00	(S-7)	
120+00 8 FT. RT. CL.	HM	10.00	PCC									
125+00 16 FT. LT. CL.							HM	1.00	(S-8)	7.50	(S-7)	
130+00 16 FT. RT. CL.							HM	2.50	(S-8)	7.00	S-9, CL, LM A-6(2), LL-31 S-11	
135+00 16 FT. LT. CL.							HM	2.00	(S-8)	6.50	S-10, LT, BTY CL A-7-8(2), LL-43 S-11	
140+00 8 FT. LT. CL.	HM	10.50	PCC									
145+00 16 FT. LT. CL.							HM	2.50	(S-10)			
150+00 16 FT. RT. CL.							HM	2.50	(S-10)			
155+00 16 FT. LT. CL.							HM	2.00	S-11, SC NP	4.00	(S-10)	
160+00 8 FT. RT. CL.	HM	12.50	PCC									

KEY:
 HM ASPHALTIC CONCRETE
 SC SOIL CEMENT
 PCC PORTLAND CEMENT CONCRETE
 SCG SAND CLAY GRAVEL
 ST SURFACE TREATMENT
 CL CENTERLINE

REMARKS: ALL BORINGS ON SHOULDERS 2' IN DEPTH
 HIGH PI MATERIAL IN SHOULDER SUBGRADE STA. 110+00 - 130+00

STATE OF LOUISIANA
 PROFESSIONAL ENGINEER
 Otis E. Peterson, Jr.
 REG. No. 13306
 DISTRICT OF BOSSON
 IN
 Otis Peterson 1-29-09

SUBMITTED BY: CARL K. HARWELL DATE BORED: 1/21/2009 LAB ENGINEER

Pavement Preservation

Overlay Example

1-58

S.P. 023-06-0065

LOCATION STATION (FT.)	ROADWAY					SHOULDER					
	SURFACE		BASE		SUBBASE	SURFACE		BASE		SUBBASE	
	TYPE	THICKNESS	TYPE	THICKNESS	TYPE	THICKNESS	TYPE	THICKNESS	TYPE	THICKNESS	
160+00	16 FT. RT. CL.						HM	2.00	(S-11)	4.00	S-12, LL-03 A-6(08), LL-03 P-11.7
165+00	16 FT. LT. CL.						HM	2.00	(S-11)	4.00	(S-12)
170+00	16 FT. RT. CL.						HM	2.00	(S-11)	3.00	(S-9)
175+00	16 FT. LT. CL.						HM	1.50	(S-11)	5.00	(S-9)
180+00	6 FT. LT. CL.	HM	8.00	PCC							
	16 FT. RT. CL.						HM	2.00	(S-11)	4.50	(S-12)
185+00	16 FT. LT. CL.						HM	2.00	(S-12)		
190+00	16 FT. RT. CL.						HM	2.50	(S-12)		
195+00	16 FT. RT. CL.						HM	2.50	S-13, SC NP	6.00	(S-12)
195+00	16 FT. LT. CL.						HM	2.00	S-14, LT STY CL A-6(08), LL-03 P-11.7		
200+00	6 FT. RT. CL.	HM	11.50	PCC							
	16 FT. RT. CL.						HM	3.00	(S-13)		
205+00	16 FT. LT. CL.						HM	2.00	(S-12)	4.00	(S-14)

KEY:
 HM ASPHALTIC CONCRETE
 SC SOIL CEMENT
 PCC PORTLAND CEMENT CONCRETE
 SCG SAND CLAY GRAVEL
 ST SURFACE TREATMENT
 CL CENTERLINE

REMARKS: ALL BORINGS ON SHOULDERS 3' IN DEPTH
 HIGH PI MATERIAL IN SHOULDER SUBBASE

SUBMITTED BY: CARL K. HARWELL DATE BORED: 1/21/2009 LAB ENGINEER

STATE OF LOUISIANA
 Otis E. Peterson, Jr.
 REG. No. 13306
 PROFESSIONAL ENGINEER
 IN
 CIVIL ENGINEERING

1-59

S.P. 023-06-0065

LOCATION STATION (FT.)	ROADWAY					SHOULDER					
	SURFACE		BASE		SUBBASE	SURFACE		BASE		SUBBASE	
	TYPE	THICKNESS	TYPE	THICKNESS	TYPE	THICKNESS	TYPE	THICKNESS	TYPE	THICKNESS	
210+00	16 FT. RT. CL.						HM	2.00	(S-14)		
215+00	16 FT. LT. CL.						HM	1.50	(S-13)	7.00	(S-14)
220+00	6 FT. LT. CL.	HM	9.50	PCC							
	16 FT. RT. CL.						HM	2.50	(S-13)	7.00	(S-14)
225+00	16 FT. LT. CL.						HM	2.00	S-15, LL-04 A-6(07), LL-01 P-11.7		
230+00	16 FT. RT. CL.						HM	1.50	(S-13)	4.00	(S-13)
235+00	16 FT. LT. CL.						HM	2.00	(S-13)	5.00	(S-15)
240+00	6 FT. RT. CL.	HM	10.00	PCC							
	16 FT. RT. CL.						HM	2.00	S-16, EC NP	8.00	(S-16)
245+00	16 FT. LT. CL.						HM	2.50	(S-16)	6.00	(S-13)
248+00	16 FT. RT. CL.						HM	1.50	(S-16)	4.00	S-17, LL-04 A-6(08), LL-01 P-11.7
255+00	16 FT. LT. CL.						HM	3.00	(S-16)	5.00	(S-17)

KEY:
 HM ASPHALTIC CONCRETE
 SC SOIL CEMENT
 PCC PORTLAND CEMENT CONCRETE
 SCG SAND CLAY GRAVEL
 ST SURFACE TREATMENT
 CL CENTERLINE

REMARKS: ALL BORINGS ON SHOULDERS 3' IN DEPTH

SUBMITTED BY: CARL K. HARWELL DATE BORED: 1/21/2009 LAB ENGINEER

STATE OF LOUISIANA
 Otis E. Peterson, Jr.
 REG. No. 13306
 PROFESSIONAL ENGINEER
 IN
 CIVIL ENGINEERING

Pavement Preservation

Overlay Example

09-1

S.P. 023-06-0066												SHEET NUMBER 55		
LOCATION STATION (FT.)	ROADWAY						SHOULDER						DISTRICT	PROJECT
	SURFACE		BASE		SUBBASE		SURFACE		BASE		SUBBASE			
	TYPE	()	TYPE	()	TYPE	THICKNESS	TYPE	()	TYPE	()	TYPE	THICKNESS		
260+00	8 FT.	LT CL	HM	11.00	PCC									
260+00	16 FT.	RT CL					HM	5.00	SP-10, SUB L/M A-4(D1), LL-23 #200					
	FT.	CL												
	FT.	CL												
	FT.	CL												
	FT.	CL												
	FT.	CL												
	FT.	CL												
	FT.	CL												
	FT.	CL												
	FT.	CL												
	FT.	CL												
	FT.	CL												
	FT.	CL												

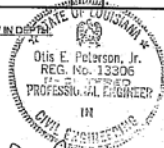
<p>KEY:</p> <p>HM ASPHALTIC CONCRETE</p> <p>SC SOL CEMENT</p> <p>PCC PORTLAND CEMENT CONCRETE</p> <p>SCG SAND CLAY GRAVEL</p> <p>ST SURFACE TREATMENT</p> <p>CL CENTERLINE</p>	<p>REMARKS: ALL BORINGS ON SHOULDERS 3' IN DIAMETER</p>	 <p>Submitted by: <u>CARL K. HARWELL</u> DATE BORED: <u>1/21/2008</u> LAB ENGINEER</p> <p style="text-align: right;"><i>Otis Peterson 1-29-09</i></p>
--	---	--

DISTRICT LAB BORINGS FOR PROJECTS

PROJECT NO.

DATE

BY

IN CHARGE

APPROVED